

緑地求積図(その4) 縮尺 1:500

Table with 6 columns: 測点名, 境界標, X座標, Y座標, Yn+1-Yn-1, Xn(Yn+1-Yn-1). Includes data for 緑地 1 5 and 緑地 2 0.

Table with 6 columns: 測点名, 境界標, X座標, Y座標, Yn+1-Yn-1, Xn(Yn+1-Yn-1). Includes data for 緑地 2 0 and 緑地 2 1.

Table with 6 columns: 測点名, 境界標, X座標, Y座標, Yn+1-Yn-1, Xn(Yn+1-Yn-1). Includes data for 緑地 1 6 and 緑地 2 1.

Table with 6 columns: 測点名, 境界標, X座標, Y座標, Yn+1-Yn-1, Xn(Yn+1-Yn-1). Includes data for 緑地 2 1 and 緑地 2 2.

Table with 6 columns: 測点名, 境界標, X座標, Y座標, Yn+1-Yn-1, Xn(Yn+1-Yn-1). Includes data for 緑地 1 7 and 緑地 2 2.

Table with 6 columns: 測点名, 境界標, X座標, Y座標, Yn+1-Yn-1, Xn(Yn+1-Yn-1). Includes data for 緑地 2 2 and 緑地 2 3.

Table with 6 columns: 測点名, 境界標, X座標, Y座標, Yn+1-Yn-1, Xn(Yn+1-Yn-1). Includes data for 緑地 1 8 and 緑地 2 3.

Table with 6 columns: 測点名, 境界標, X座標, Y座標, Yn+1-Yn-1, Xn(Yn+1-Yn-1). Includes data for 緑地 2 3 and 緑地 2 4.

Table with 6 columns: 測点名, 境界標, X座標, Y座標, Yn+1-Yn-1, Xn(Yn+1-Yn-1). Includes data for 緑地 1 9 and 緑地 2 4.

Table with 6 columns: 測点名, 境界標, X座標, Y座標, Yn+1-Yn-1, Xn(Yn+1-Yn-1). Includes data for 緑地 2 4 and 緑地 2 5-1.

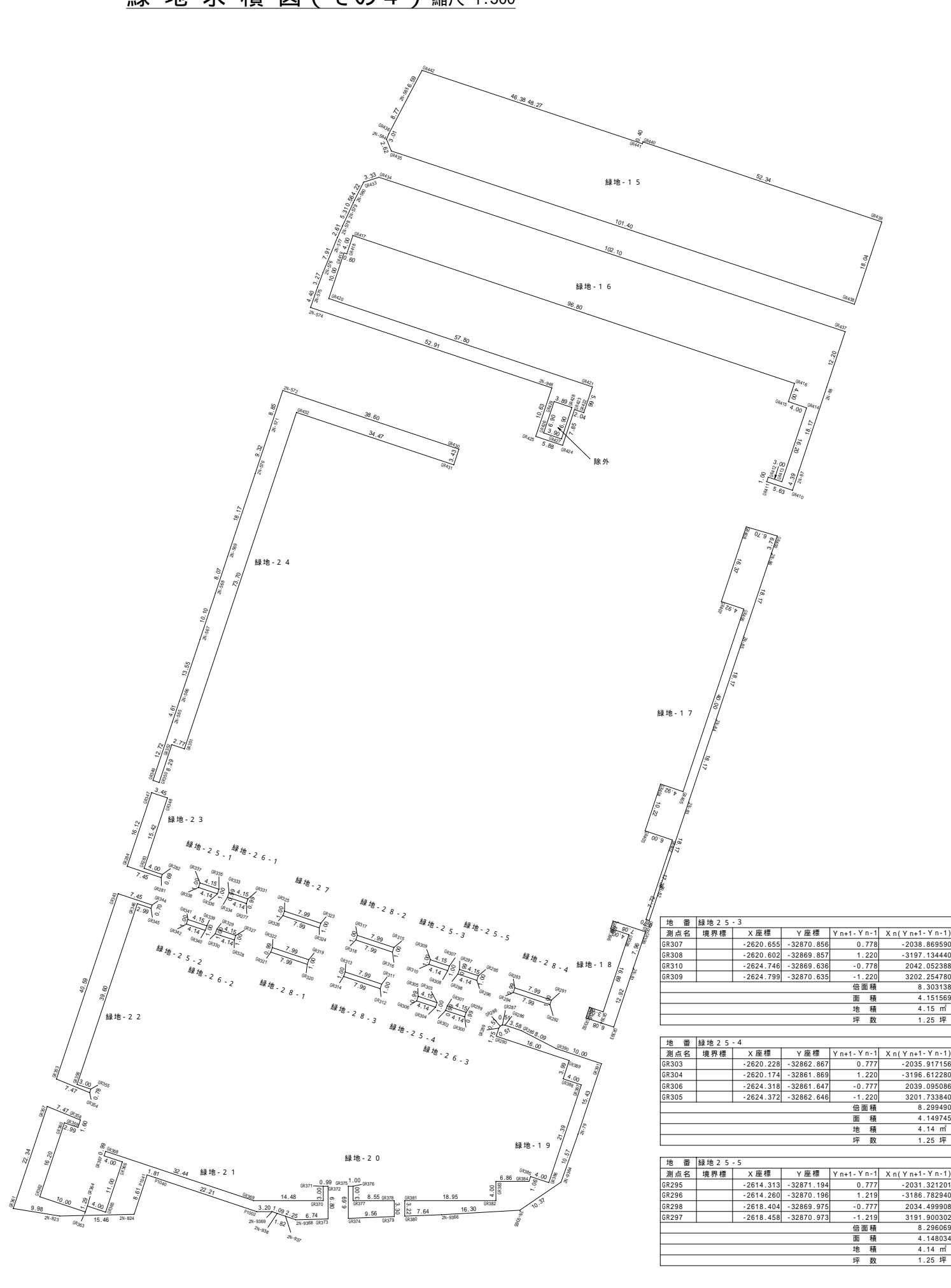

Table with 6 columns: 測点名, 境界標, X座標, Y座標, Yn+1-Yn-1, Xn(Yn+1-Yn-1). Includes data for 緑地 2 6-1.

Table with 6 columns: 測点名, 境界標, X座標, Y座標, Yn+1-Yn-1, Xn(Yn+1-Yn-1). Includes data for 緑地 2 6-2.

Table with 6 columns: 測点名, 境界標, X座標, Y座標, Yn+1-Yn-1, Xn(Yn+1-Yn-1). Includes data for 緑地 2 6-3.

Table with 6 columns: 測点名, 境界標, X座標, Y座標, Yn+1-Yn-1, Xn(Yn+1-Yn-1). Includes data for 緑地 2 7.

Table with 6 columns: 測点名, 境界標, X座標, Y座標, Yn+1-Yn-1, Xn(Yn+1-Yn-1). Includes data for 緑地 2 8-1.

Table with 6 columns: 測点名, 境界標, X座標, Y座標, Yn+1-Yn-1, Xn(Yn+1-Yn-1). Includes data for 緑地 2 8-2.

Table with 6 columns: 測点名, 境界標, X座標, Y座標, Yn+1-Yn-1, Xn(Yn+1-Yn-1). Includes data for 緑地 2 8-3.

Table with 6 columns: 測点名, 境界標, X座標, Y座標, Yn+1-Yn-1, Xn(Yn+1-Yn-1). Includes data for 緑地 2 8-4.

Table with 6 columns: 測点名, 境界標, X座標, Y座標, Yn+1-Yn-1, Xn(Yn+1-Yn-1). Includes data for 緑地 2 5-3.

Table with 6 columns: 測点名, 境界標, X座標, Y座標, Yn+1-Yn-1, Xn(Yn+1-Yn-1). Includes data for 緑地 2 5-4.

Table with 6 columns: 測点名, 境界標, X座標, Y座標, Yn+1-Yn-1, Xn(Yn+1-Yn-1). Includes data for 緑地 2 5-5.

工事箇所: 緑地求積図(その4) NO. / 製図 平成 年月日 縮尺 1:500. Includes fields for design, check, and approval.